

**9469100**

1/2" Thermostatic Trim  
With Diverter And  
Volume Control

needs rough VALVE 691

**FINISHES**

9469100PC Polished Chrome  
9469100BN Brushed Nickel

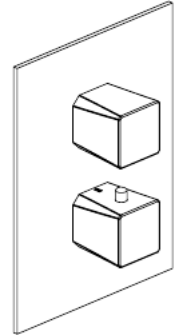

**STANDARDS** 

- Compliant with ASME A112.18.1 - CSA B125.1 when sold with rough valve
- Certified by IAPMO R&T Lab when sold with rough valve

**FEATURES**

Solid Brass Construction  
Complete Trim Kit  
Mechanical diverter Controlling water flow  
Thermo Control Cartridge  
Independent Temperature Control  
Stop limit temperature device included  
Step-By-Step Installation Instructions

**DIMENSIONS**

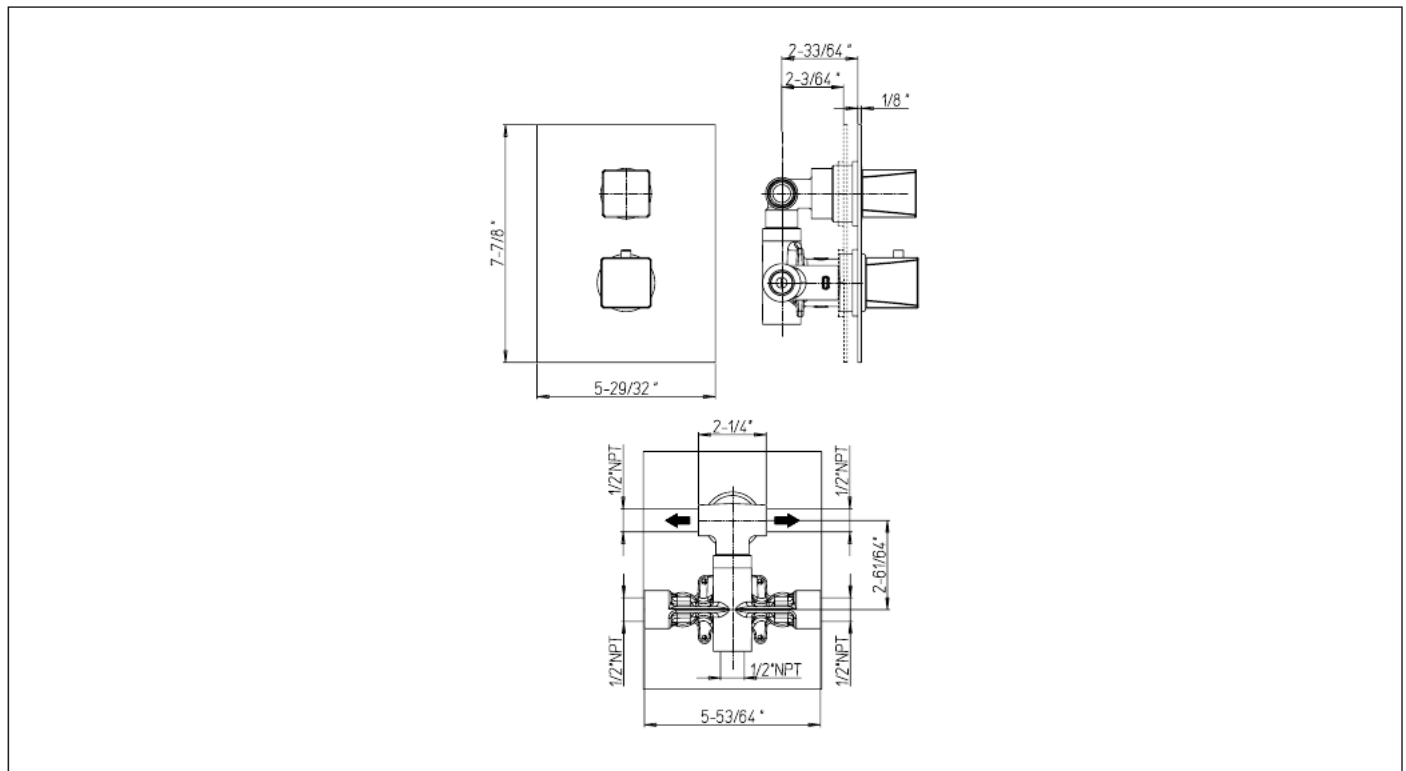

Project \_\_\_\_\_  
Contractor \_\_\_\_\_